

PATENTED "WINDLOK" FEATURE

ALL DIMENSIONS SHOWN ARE FOR ACTUAL DOOR COMPONENTS. SEE FRAMING DETAIL FOR INSTALLATION CLEARANCES.

* STANDARD FRAMING DETAILS ARE NOT ADEQUATE FOR A JAMB MOUNTED TRAVELLING WINDBAR. USE W10 x 45 WIDE FLANGE BEAM IN PLACE OF 8" x 4" RECT. H.S.S. UPRIGHTS AND C10 x 15.3 CHANNEL IN PLACE OF 3" x 3" ANGLE FALSE LINTEL.

DOOR OPTIONS	OPTIONAL CONTROLS	ELECTRICAL SPECIFICATIONS
<input type="checkbox"/> GUIDE MNT. TRAVELLING WINDBAR	<input type="checkbox"/> PULLCORDS	OPERATOR: <input type="checkbox"/> FDGH/ECH
<input type="checkbox"/> * JAMB MNT. TRAVELLING WINDBAR	<input type="checkbox"/> LOOP DETECTOR	----- HP DOOR SPEED: ----- IPS
<input type="checkbox"/> WINDOWS, No. REQ'D -----	<input type="checkbox"/> MOTION DETECTOR	----- VOLTS ----- PHASE ----- CYCLES
<input type="checkbox"/> 100,000 CYCLE C'BAL SPRINGS	<input type="checkbox"/> PHOTO CELL	EEMAC (NEMA) STANDARD
<input type="checkbox"/> OTHER - GIVE DETAILS	<input type="checkbox"/> WIRELESS REMOTE	CONTROL PANEL: -----
	<input type="checkbox"/> REMOTE PUSH BUTTON ST'N	REMOTE PUSH BUTTON ST'N: -----
	<input type="checkbox"/> AUTOMATIC CLOSE	SAFETY EDGE: <input type="checkbox"/> ELECTRIC <input type="checkbox"/> PNEUMATIC
	<input type="checkbox"/> FUSED DISCONNECT	

M & I DOOR SYSTEMS LTD.		
SHOP DRAWING		
TITLE: LARGE RE-COIL-AWAY R.H.		
DOOR TYPE: LARGE RE-COIL-AWAY R.H.		
FEATURES: DOOR MOUNTED, TANDEM OUTBOARD C'BAL SPRINGS AND FDGHE		
LIMITATIONS: MAX.DOOR WIDTH 40', MAX.DOOR HEIGHT DEPENDS ON WIDTH		
DATE DR'N: AUGUST 21, 1995	FOR FRAMING DETAILS: F-2213-DR	
DR'N BY: CLARK SPENCE	REV. DATE: MAY 4, 2000	REVNO: D
END USER:	SERIAL NO.:	
DOOR SIZE:	DWG NO. S-2213-DR	

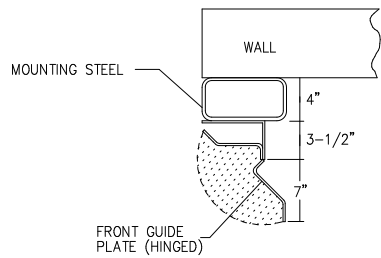

SPACE REQUIRED FOR OPENING GUIDE

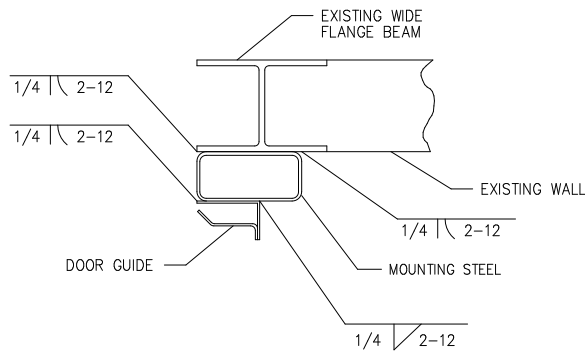

MOUNTING DOOR GUIDE ON WIDE FLANGE BEAM

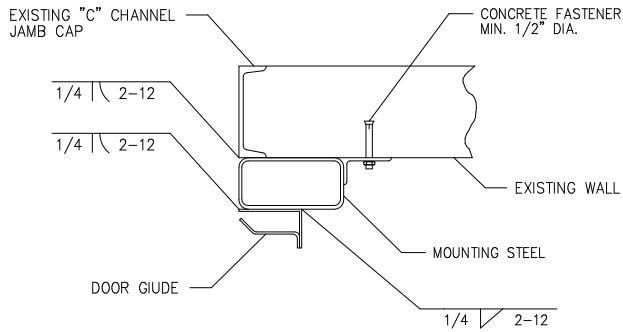

MOUNTING DOOR GUIDE ON "C" CHANNEL JAMB CAP

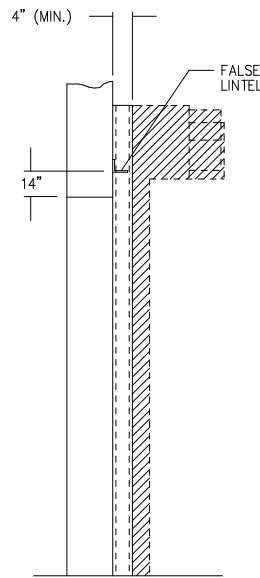
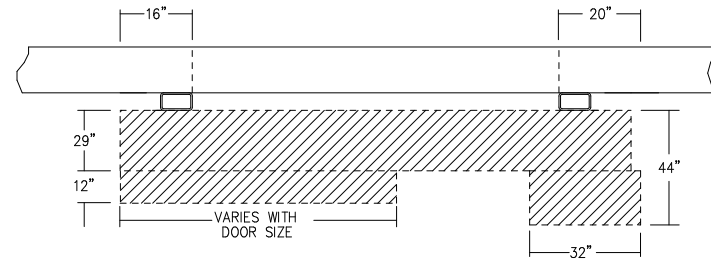

SECTION "A-A"

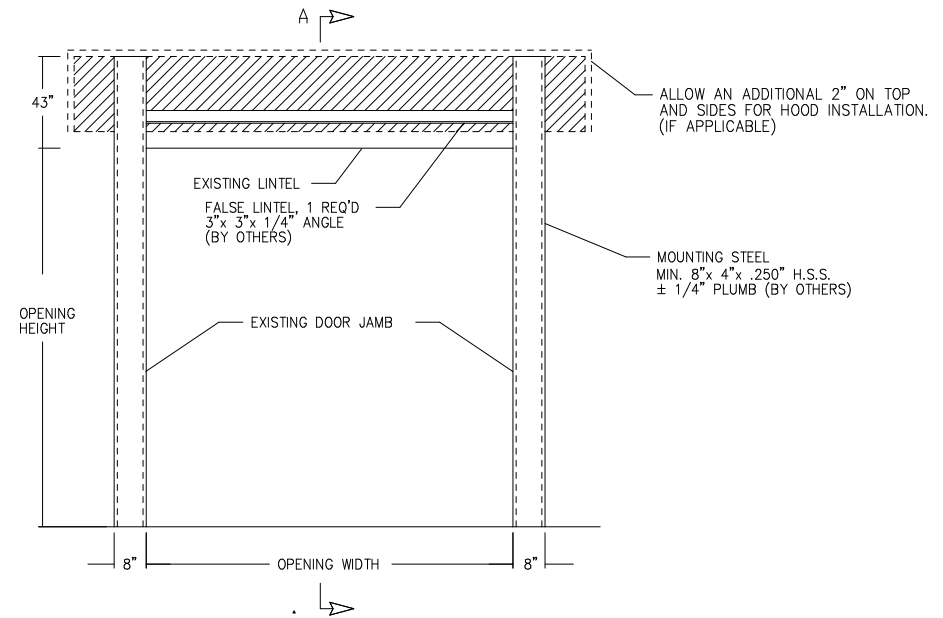

RECOMMENDED CONCRETE FASTENERS
 BLOCK WALLS: THRU WALL C/W 6"x6"x1/4"
 BACKING PLATE (BY OTHERS)
 SOLID WALLS: WEDGE ANCHOR

GENERAL NOTES

- SHADED AREAS REPRESENT INSTALLATION CLEARANCES. REFER TO SHOP DRAWING FOR ACTUAL DIMENSIONS OF DOOR COMPONENTS.
- ALL MOUNTING STEEL MUST PROTRUDE AT LEAST 4" FROM LINTEL SURFACE.
- STANDARD FRAMING MATERIALS ARE NOT ADEQUATE FOR A JAMB MOUNTED TRAVELLING WINDBAR TO CLEAR THE LINTEL. USE W10 x 45 WIDE FLANGE BEAM IN PLACE OF 8" x 4" RECT. H.S.S. (MOUNTING STEEL) AND C10 x 15.3 CHANNEL IN PLACE OF 3" x 3" ANGLE (FALSE LINTEL).
- EXISTING MOUNTING STRUCTURE MUST BE ABLE TO WITHSTAND FORCES EXERTED BY DOOR (DOOR WEIGHT APPROX.).

DOOR # 512

M & I DOOR SYSTEMS LTD.			
FRAMING DETAILS			
DOOR TYPE		RE-COIL-AWAY RIGHT-HAND	
FEATURES: DOOR MOUNTED, OUTBOARD COUNTERBALANCE SPRINGS AND OPERATOR			
LIMITATIONS: MAX. DOOR WIDTH 40', MAX. DOOR HEIGHT DEPENDS ON WIDTH			
DATE DR'N:	AUGUST 22, 1995	FOR SHOP DRAWING:	S-2213-DR
DR'N BY:	CLARK SPENCE	REV. DATE:	MAY 4, 2000
END USER:			SERIAL NO.:
DOOR SIZE:			DWG NO. F-2213-DR
REV. NO.: E			